

NEW BOX-X RANGE

PORTABLE AIR

[Introduction](#)

[Product Range](#)

[Market](#)

[Key Benefits](#)

[Reasons to choose](#)

[Main data](#)

[Options](#)

[Tools & communications](#)

Atlas Copco



Portable Air

Welcome!

In this presentation you would learn about various features and benefits of the XAS boX range
At the end of this session, we expect you to have understanding of:

- Positioning of this product among the different product lines
- Benefits of various features
- Various options available
- Sales tools

FORWARD THINKING→



Portable Air

Why did we make new BOX-XAS range from medium air ?

BOX XAS



“ The boX range was developed for the customers who need a simple, efficient, robust and reliable machine for tough working environments. Perfect for high or low ambient temperatures, dusty environments, high altitude and working with low quality diesel.

The simplicity of new boX range will bring our customers the lowest cost of ownership when taking into account the initial purchase cost, maintenance costs and operational costs. Simplicity makes a big difference within the boX range.

Haiying Cong, Product Manager. ”

Portable Air

Portable energy solutions portfolio

AIR COMPRESSORS

READY TO GO

1-5 m³/min
7-12 BAR



VERSATILITY

7-22 m³/min
7-20 bar



PRODUCTIVITY PARTNER

19-64 m³/min
10-35 bar



GENERATORS

PORTABLE

1,6-13,9 kVA



MOBILE

9-1250* kVA



INDUSTRIAL

10-1250 *kVA



Multiple configurations available to produce power for any application.

DEWATERING PUMPS

ELECTRIC SUMMERSIBLE

275-16.500 l/min



CENTRIFUGAL DIESEL DRIVEN

833-9833 l/min



SMALL PORTABLE

210-2500 l/min



LIGHT TOWERS

LED



METAL HALIDE



SOLAR



Portable Air

Portable Air solutions portfolio

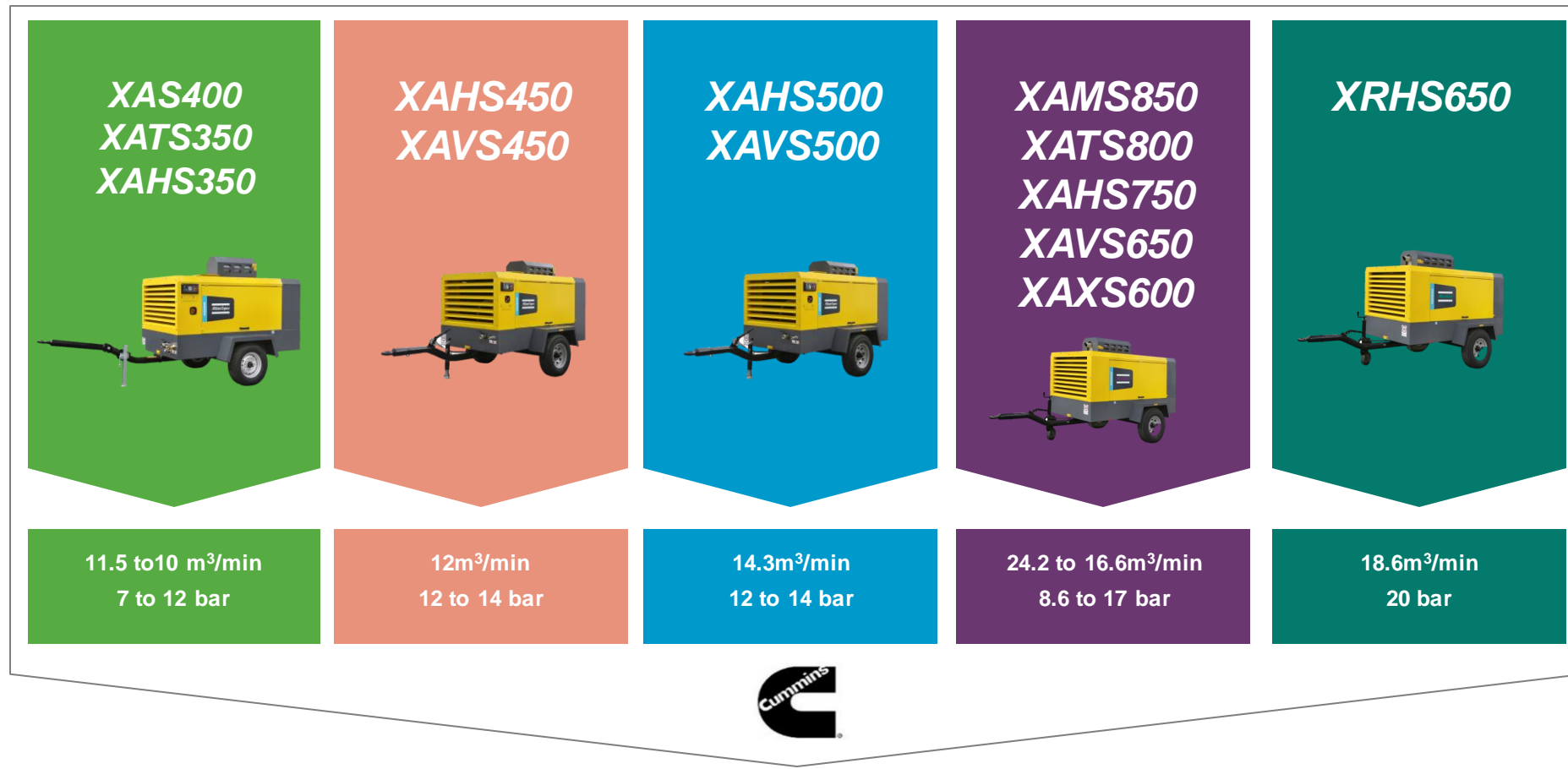

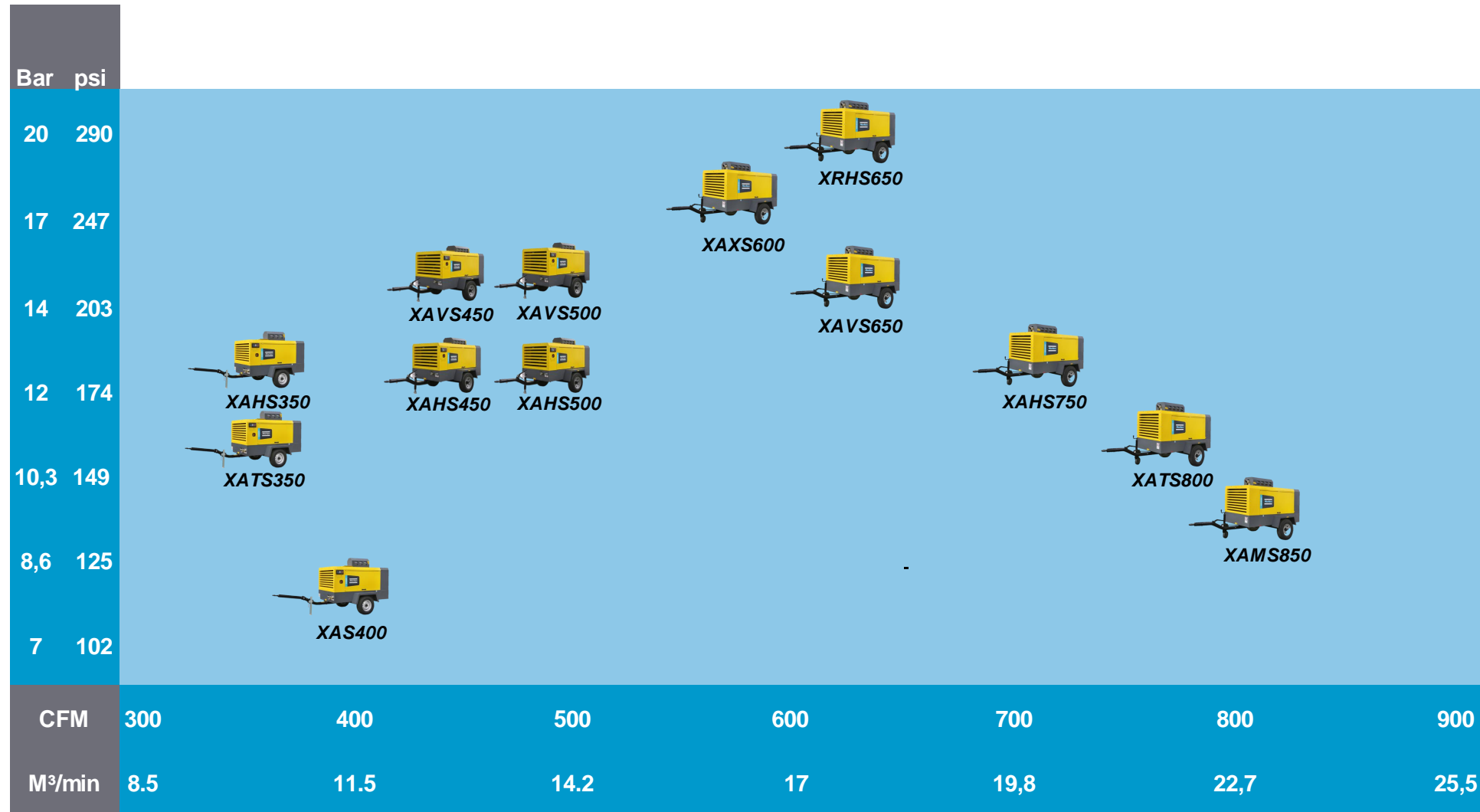
Portable Air

Portable Air

Applications

Construction



Handheld Pneumatic Tools



Ground Engineering Drilling



Shot Crete Blasting



Directional Drilling



Water Well Drilling



Mining



Dimensional Stone Quarry Drilling



Blast Hole Drilling



Utilities



Abrasive Blasting



Dry Ice Blasting



Cable Blowing



Portable Air**Which unit for which application ?**

	Pneumatic Tools	Dimensional Stone Quarry	Abrasive Blasting	Dry Ice Blasting	Shot Crete blasting	Fiber-optic Cable Blowing	Blast Hole Drilling	Water Well Drilling	Directional drilling	Pipeline Services
XAS 400	●	●	●	●						
XATS 350	●		●							
XAHS 350			●			●				
XAHS 450			●		●	●				
XAVS 450		●					●			
XAHS 500			●		●					
XAVS 500		●					●			

Portable Air**Which unit for which application ?**

	Pneumatic Tools	Dimensional Stone Quarry	Abrasive Blasting	Dry Ice Blasting	Shot Crete blasting	Fiber-optic Cable Blowing	Blast Hole Drilling	Water Well Drilling	Directional drilling	Pipeline Services
XAMS 850	●	●	●							
XATS 800			●							
XAHS 750					●					●
XAVS 650		●					●			●
XAXS 600		●					●	●	●	
XRHS 650		●					●	●	●	

Portable Air

You. Not us

1

- High productivity from simple box design
 - Stable flow and pressure.
 - Reliable performance for tough working environment
- Lower operation cost
 - High fuel Efficiency from AC element and Cummins engine
- Versatile for various applications
 - Many variants with different pressures and flows.
- Dual solutions for different customers' request
 - Mechanical engine and control panel
 - Electronic engine and XC2003 controller



Higher
Productivity



Versatile



Index

Portable Air

Engineered. Not assembled

2

- Simple vessel cover for easy service
 - One hour saving for the service time
- XC2003 controller (for electric engine)
 - LCD color screen and IP65 for tough working condition
 - Fully integrated ECU makes easy diagnostics
- Top mounted muffler for less fire risk
- Integrated top tank for less leakage risk



Serviceability



Easy to
Operate

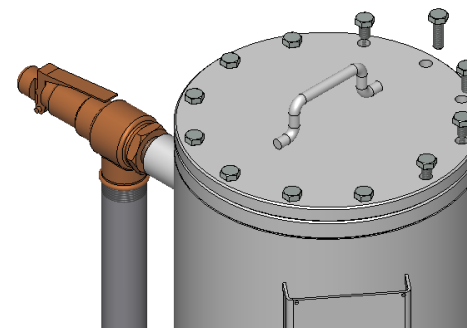

Simple vessel Cover



XC2003 Controller



Top mounted muffler



Integrated top tank



Index

Portable Air

Solutions. Not compromise

3

- Designed for dusty environments
 - Heavy duty air filters with safety cartridge as standard
- Design for bad fuel quality
 - Additional fuel filter as standard.
- Metal braiding hose as standard for longer life time
- Designed for 50°C ambient temperature
- Designed for 4,500 meters high altitude



Proven
Reliability



Heavy duty
filters



Heavy duty air filter



Additional fuel filter



Metal braiding hose



High altitude test



Index

Portable Air

Efficient. Not wasteful

4

- Atlas Copco in-house developed high efficient screw element
- Cummins high efficient mechanical and electronic engines
- FuelXpert as standard for Size 1.5 and Size 2LP
 - Improve 15% fuel efficiency at partial load.
- Small footprint for easy transportation



Efficient element



Cummins engine



Fuelxpert



Transport
Efficiency



Index

Portable Air

Uptime. Not downtime

5

- 1000 hours service interval for the compressor.
 - Atlas Copco compressor oil for various working environment
- 500 hours service interval for the engine.
- Simple vessel cover for easy service
- Heavy duty filters to safe guard the engine and screw element



Heavy duty air filter



Additional fuel filter



Service
Efficiency

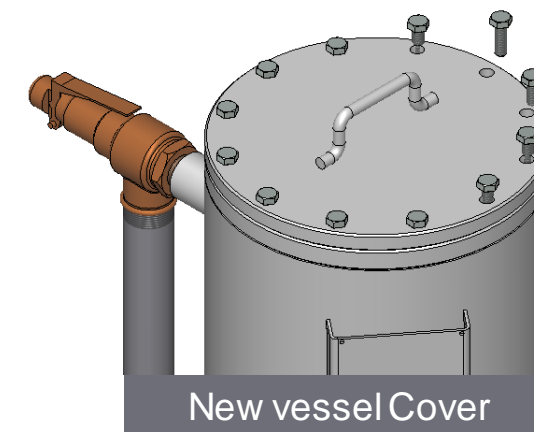

New vessel Cover



Portable Air

Leader. Not follower

6

- Simple box design for tough working environment
 - Hot and cold environments
 - High altitude
 - Dusty environments and environments with bad fuel quality
- Best efficiency in the market
 - XAMS 850 with more flows than any competition
 - XRHS 650 with 15% better efficiency than competition
 - Smallest footprint than any competition
- Lowest operation cost
 - Less capital investment
 - Less operation cost



Portable Air

Size1 and Size1.5



Duel engine solutions:
Mechanical and electronic

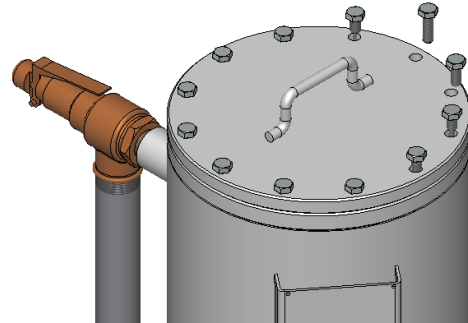

Simple vessel cover:
Easy for service



Heavy duty air filter with safety
cartridge as standard



Additional fuel filter as standard



FuelXpert for fuel savings at
partial load (only for
XAHS/XAVS500)

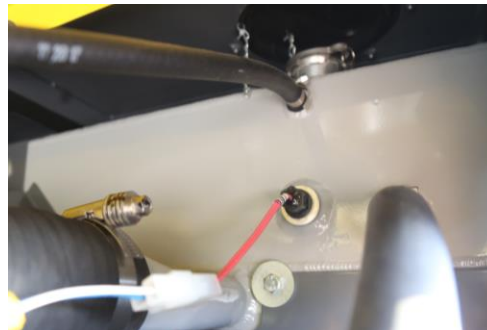

Integrated top tank with radiator:
less risk for leakage and corrosion



XC2003 controller with IP65
protection: easy to operate



Top mounted muffler for less fire
risk and heat load

Portable Air**Competition comparison for Size1 and Size1.5**

Description	AC XAS400	Airman PDS390	Doosan P425WCU	Kaeser M122/M123
Duel engine offering: mechanical and electronic engines	✓	✗	✗	✓
Advanced controller or simple control panel as duel offerings	✓	✗	✗	✗
Muffler outside to avoid fire risk and extra heat load	✓	✗	✗	✗
Simple vessel cover design. Save one hour of service time to change oil separator element	✓	✗	✗	✗
Extra cooling capacity for hot environment	✓	✗	✓	✗
AC high efficient element and long life time	✓	✗	✗	✗
Optimized air filtration system for tough application. Safety cartridge as standard	✓	✓	✓	✗
Additional fuel filter as standard for bad fuel quality	✓	✗	✗	✗
Integrated top tank with radiator to avoid leakage	✓	✗	✗	✗
Fuelxpert on XAHS500 and XAVS500: to save 15% fuel at partial load	✓	✗	✗	✗

Portable Air

Size2LP/XRHS650



XC2003 controller with IP65 protection: easy to operate

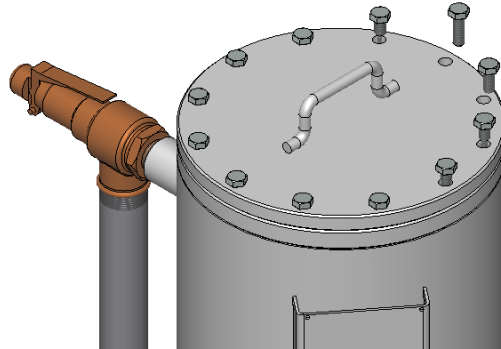

Simple vessel cover: easy for service



Heavy duty air filter with safety cartridge as standard



Additional fuel filter as standard



FuelXpert for fuel savings at partial load



Integrated top tank with radiator: less risk for leakage and corrosion



Metal braiding hose with more safety and life time



Top mounted muffler for less fire risk and heat load

Portable Air**Competition comparison for Size2LP**

Description	AC XAMS850	Airman PDSF750S	Doosan 9/235HA	Kaeser M235
High efficient electronic engines	✓	✓	✗	✓
Advanced controller with IP 65 protection and easy to operate	✓	✗	✗	✗
Muffler outside to avoid fire risk and extra heat load	✓	✗	✗	✗
Simple vessel cover design. Save one hour of service time to change oil separator element	✓	✗	✗	✗
Extra cooling capacity for hot environment	✓	✗	✓	✗
AC high efficient element with long life time.: at least 5% more flow than others.	✓	✗	✗	✗
Optimized air filtration system for tough application. Safety cartridge as standard	✓	✓	✓	✗
Additional fuel filter as standard for bad fuel quality	✓	✗	✗	✗
Integrated top tank with radiator to avoid leakage	✓	✗	✗	✗
Fuelxpert as standard: to save 15% fuel at partial load	✓	✗	✗	✗
Metal braiding oil flexible hose as standard: longer lifetime than rubber hose.	✓	✗	✗	✗
Duel offerings of single axle trailer and two axle wagon	✓	✗	✗	✗



Portable Air

Key benefits



Higher
Productivity



High
Altitude
Options



Easy to
Operate



Fuel
Efficiency



Full Shift
Autonomy



Service
Efficiency



Compact
& Light



Heavy
duty filters



Transport
Efficiency



T2/T3
engine
emission



Proven
Reliability



-10 to
50 °C



Portable Air**Technical Data for Size1 and Size1.5**

		XAS400	XATS350	XAHS350	XAHS450	XAVS450	XAHS500	XAVS500
Max. Pressure	bar	7	10.3	12	12	14	12	14
	PSI	100	150	175	175	200	175	200
Flow at max. pressure	m ³ /min	12	10	10	13	13	14.5	14.5
	l/s	191	166	166	208	208	238	238
	CFM	410	360	360	441	441	504	504
Cummins engine model		4BTAA3.9/QSB3.9			6BTAA5.9/QSB5.9		QSB5.9	
Engine power	kW	93			132		152	
Dimensions Box (LxWxH)	mm	2458 x1350 x1525			2800 x1400 x1600		2923 x1400 x1600	
Wet weight Box	kg	1600			1825		2125	
Dimensions with trailer (LxWxH)	mm	4120 x1890 x1991			4140x1940x2141		4230 x1940 x 2141	
Wet weight with trailer	kg	1700			2000		2300	



Index

Portable Air**Technical Data for Size2LP and XRHS650**

		XAMS850	XATS800	XAHS750	XAVS650	XAXS600	XRHS650
Max. Pressure	bar	8.6	10.3	12	14	17	20
	PSI	125	150	175	200	250	300
Flow at max. pressure	m³/min	24.5	22.5	21	18.5	17	17
	l/s	403	372	343	307	277	310
	CFM	854	788	727	651	587	657
Cummins engine model		QSB6.7					
Engine power	kW	194					
Dimensions Box (LxWxH)	mm	3177 x 1470 x 1987					
Wet weight Box	kg	2500					2800
Dimensions with trailer (LxWxH)	mm	4893 x 2010 x 2313					
Wet weight with trailer	kg	2800					3000

Portable Air

Main Options



Single axle



Wagon for Size2LP

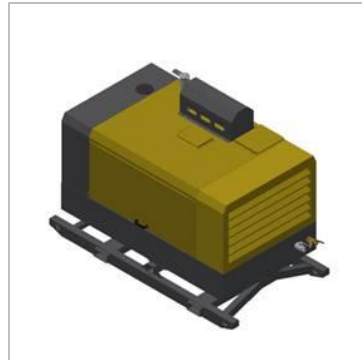

Skid

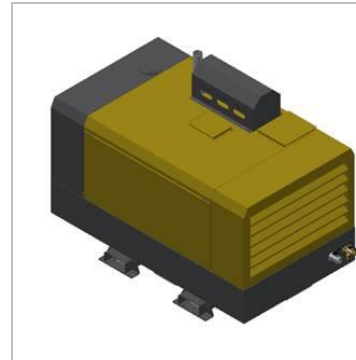

Support mount



Jockey wheel

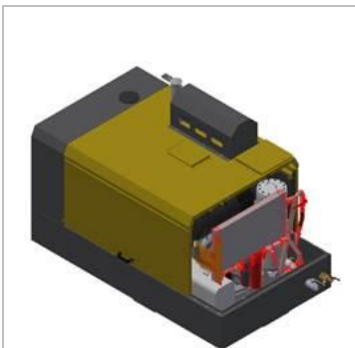

After cooler

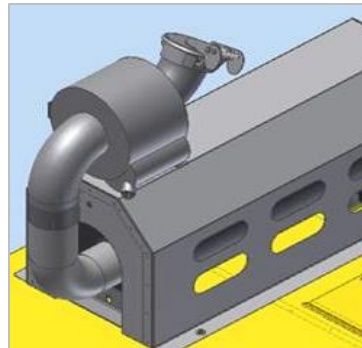

Refinery kit



Cold Start



Index

Portable Air

Tools and Communication

Brochure

Think inside the box

The new XAS box range is the result of 10 years of continuous development and addresses the changing needs of our customers. This range, from 400-850 cfm, combines the rugged durability you need with the performance efficiency you deserve.

When we focus on efficiency within this range, it's all about the strategic triangle of size, flow and fuel efficiency. Excelling in one of these areas is wasted excellence if you cannot provide the other two. Therefore, our promise to you is an industry leading range of optimized size-to-flow compressors, which have unparalleled levels of fuel efficiency and autonomy.

This range is also designed to withstand the toughest working conditions. With a standard operating temperature range of -10°C to +50°C and a strong undercarriage, the range's robust nature guarantees reliable operation. The design, controller and modularity put you in control. You will see we have also focussed heavily on ease of service to ensure uptime and utilization. This range is all about you!

LOWER CAPITAL INVESTMENT

One machine covers multiple applications

INCREASED UTILIZATION

Simple service and long service intervals

FUEL SAVINGS

Both efficiency and autonomy

COMPACT SIZE

With maximum flow

HIGH AMBIENT TEMPERATURE PERFORMANCE GUARANTEED

Built better. Built for you!

Depending on the model, we offer a choice of a mechanical or electronic engine. We also offer our patented FuelXpert system on many models. By matching the air demand needs to the engine speed, the consumption of fuel is optimized. This fast acting fuel saving system is continuous during the running of the compressor – with the largest benefit at partial load. In short, we are proud to offer a range of compressors with market leading efficiency, due to the combination of our in-house patented screw element coupled with a Cummins engine.

XAS850 controller with IP65 protection and easy operation*

Simple vessel design for ease of service.

Heavy duty air filter with safety cartridge as standard.

Additional fuel filter as standard to ensure engine protection.

FuelXpert for fuel savings at partial load*.

Integrated top tank to reduce leak risk and avoid corrosion.

Metal braiding hose to improve safety and longevity.

Top mounted muffler for less fire risk and heat load.

Enhanced cooling system for 50°C high ambient temperatures.

*On all units with electronic engines
+Available on select models

OPTIONS AVAILABLE

- Single axle
- Wagon
- Mounted support

- Skid
- Jockey wheel
- After-cooler

- Refinery kit
- Cold start kit

Plus many more. Please ask a representative for details.

Playbook

Take the challenge

Description	Atlas Copco XAMS850	Airman PDSF760S	Doosan 9/235HA	Kaeser M235
Highly efficient electronic engine with Stage IIIA emission	✓	✓	✗	✓
Advanced controller with IP 65 protection and easy to operate	✓	✗	✗	✗
Muffler outside to avoid fire risk and extra heat load	✓	✗	✗	✗
Simple vessel cover design. Save one hour service time	✓	✗	✗	✗
Extra cooling capacity for hot environment	✓	✗	✓	✗
Highly efficient element with longer life time	✓	✗	✗	✗
Optimized air filtration system for tough applications. Safety cartridge as standard	✓	✓	✓	✗
Additional fuel filter as standard to ensure fuel quality	✓	✗	✓	✗
Integrated top tank with radiator to avoid leakage	✓	✗	✗	✗
FuelXpert system as standard. Up to 15% fuel efficiency at partial load	✓	✗	✗	✗
Metal braiding oil flexible hose as standard: longer lifetime than rubber hoses	✓	✗	✗	✗
Duel offerings of single axle trailer and two axle wagon	✓	✗	✗	✗

Video



Index

***COMMITTED TO
SUSTAINABLE PRODUCTIVITY.***



Atlas Copco

